



 **BAREZ**[®]
TIRES

BAREZ INDUSTRIAL GROUP
GENERAL CATALOGUE
2022-2023



➤ **Contents**

Pages

➤ Introduction	2	2-3
➤ Passenger Car Radial Tires	4	4-17
➤ Truck and Bus Radial Tires (TBR)	18	18-21
➤ SUV-CUV car Radial Tires	22	22-42
➤ Light Truck ,Van Radial Tires (LTR)	43	43-46
➤ Passenger Car Bias Tires	47	47-48
➤ Light Truck Bias Tires	49	49-53
➤ Truck and Bus bias Tires	54	54-58
➤ Agricultural Tires (AG)	59	59-66
➤ Off the road Tires (OTR)	67	67-69
➤ Tire Performance diagram	70	70-71
➤ Tire Signs & Specifications	72	72
➤ Tire Specifications	73	73-76



The Barez Industrial Group (B.I.G.), the most famous tire company in Iran, was established in 1985. Thanks to the enthusiasm of consumers, the company's products entered the Iranian tire market and because of the high quality of its tires and transferred technologies, this corporation is considered as the best Iranian tire manufacturer in the last 19 years and has the most production volume among all Iranian tire companies.

After the company began designing and manufacturing, the first technical knowledge transfer was derived from Bridgestone. Gradually, the company attempted to import TRI Russian technology and Italian Marangoni know-how to produce radial car tires. During the last decades, the group - in the framework of a 10-year contract – imported the German Continental technology to manufacture a variety of radial tires. At the time being, all B.I.G. products are designed and manufactured based on German Continental technology and enter the market.

In 2017, the new Plant of Barez based on the developed technology in the B.I.G. was established in Kordestan province to reach the production capacity of 140000 Tons per year alongside with expanding Barez Kerman factory. This potential has helped Barez develop based on a global scale and gain the first rank among all tire companies in Iran in terms of production volume and quality.

In order to get along with the new trends in tire technology and move through the edge of knowledge, Barez industrial group established the first professional Research and Development (R&D) department in Iran. To achieve new tire sizes and patterns, as well as better quality, this department has tried to adopt the global production of radial tires and successfully launched the Truck Bus Radial (TBR), Passenger Car Radial (PCR), Sport Utility Vehicle (SUV), Crossover Utility Vehicle (CUV), Van Radial tires, and Off The Road (OTR) tires. It is to be noted that Barez is the only company having all-steel TBR technology and SUV design science in Iran. As a consequence, B.I.G. has had the most complete group of products in the Iran market.



It must be mentioned here that the Barez Industrial Group has conducted the complete indoor and outdoor tests. In addition, this company has the largest car and tire proving ground which was launched based on the technology of IDIADA in Spain. These approaches have led Barez to produce more comfortable, durable, and safe tires. Also, this company has got the E-mark license from Germany as well as certificates from international car manufacturers such as Renault, Benz (For heavy vehicles), Iveco, and Peugeot.

The Barez industrial group has had long-term cooperation as the Original Equipment (OE) supplier with famous automotive manufacturers including Iran Khodro, Iran Khodro Diesel, Saipa, Saipa Diesel, Zamiad, Mumut, and Maral. In the tire Replacement Equipment (RE) market as well, this cooperation has tried to be responsive to the customer demands and has established national sale systems, regular control, and price monitoring. Having nearly 400 dealers and 180 after-sales services around the country, Barez has the most extended distribution channel in Iran. Also, Barez products have been exported to some countries such as Romania, Turkey, Iraq, Pakistan, Afghanistan, Kazakhstan, Saudi Arabia, Sudan, Syria, Armenia, and Azerbaijan.

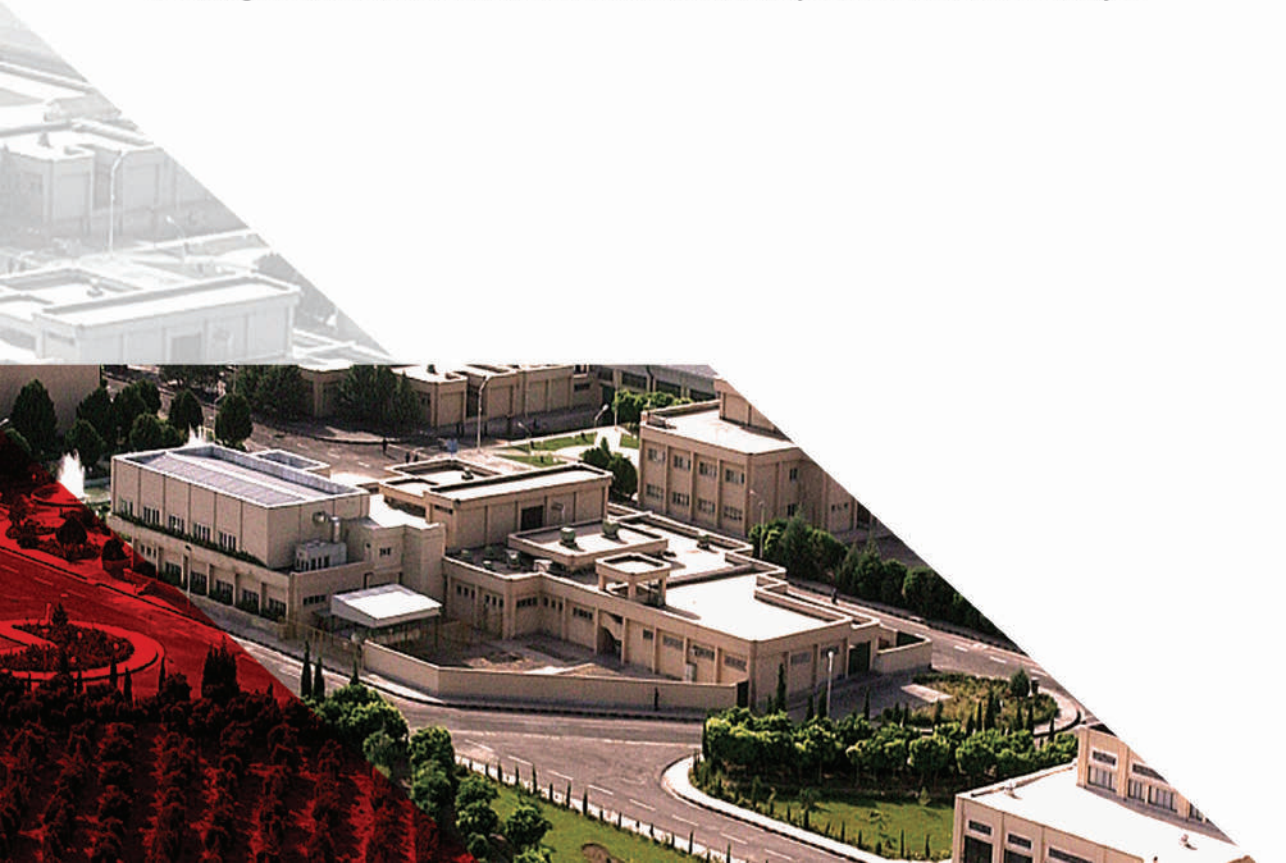

PCR (Passenger Car Radial Tire)



PREMIUM DRIVE (P648)



S (Snow)
W (Wet)
D (dry)



Wet Grip

Braking

All Season



Low Noise

Comfort

Fuel Economy

Durability

Technical Specifications

Tire Size	Tread Pattern	Aspect Ratio	Load Index	Rim Width (inch)	Speed Index	Recommended tire inflation pressure for permitted load per tire (Psi/kg)					*Overall Diameter (mm)	*Section Width (mm)
						30	32	33	35	36		
165/65 R 13	P648	65	77	5	T	30 360	32 370	33 385	35 400	36 412	545	168.3
185/65 R 14	P648	65	86	5.5	H	30 460	32 480	33 495	35 515	36 530	594	189
185/65 R 15	P648	65	88	5.5	H	30 485	32 505	33 525	35 540	36 560	622	188
195/65 R 15	P648	65	91	6	H	30 535	32 555	33 575	35 595	36 615	636	199

*Mentioned as Public guide and there maybe minor change according to tire structure.

▶ **BRILLIANT** (P660)



Technical Specifications

Tire Size	Tread Pattern	Aspect Ratio	Load Index	Rim Width (inch)	Speed Index	Recommended tire inflation pressure for permitted load per tire (Psi/kg)					*Overall Diameter (mm)	*Section Width (mm)
						30	32	33	35	36		
165/65 R 13	P660	65	77	5	T	30	32	33	35	36	544	170
						360	370	385	400	412		
175/60 R 13	P660	60	77	5	H	30	32	33	35	36	541	178.5
						360	370	385	400	412		
175/70 R 13	P660	70	82	5	H	30	32	33	35	36	576	178.5
						415	430	445	460	475		
185/65 R 14	P660	65	86	5.5	H	30	32	33	35	36	596	188.7
						460	480	495	515	530		
185/70 R 14	P660	70	88	5.5	T	30	32	33	35	36	614	189
						485	505	525	540	560		

*Mentioned as Public guide and there maybe minor change according to tire structure.

▶ **WINTERTECH** (P642)



Technical Specifications

Tire Size	Tread Pattern	Aspect Ratio	Load Index	Rim Width (inch)	Speed Index	Recommended tire inflation pressure for permitted load per tire (Psi/kg)					*Overall Diameter (mm)	*Section Width (mm)
						30	32	33	35	36		
165/65 R 13	P642	65	76	5	T	30 360	32 370	33 385	35 400	36 412	544	170
175/70 R 13	P642	70	82	5	T	30 415	32 430	33 445	35 460	36 475	576	177
185/65 R 14	P642	65	86	5.5	H	30 460	32 480	33 495	35 515	36 530	597.5	188.5
185/65 R 15	P642	65	88	5.5	H	30 485	32 505	33 525	35 540	36 560	622.5	188.5

*Mentioned as Public guide and there maybe minor change according to tire structure.

▶ **ALERIA (P601)**



D (dry)
W (Wet)
S (Snow)



Technical Specifications

Tire Size	Tread Pattern	Aspect Ratio	Load Index	Rim Width (inch)	Speed Index	Recommended tire inflation pressure for permitted load per tire (Psi/kg)					*Overall Diameter (mm)	*Section Width (mm)
						30	32	33	35	36		
175/60 R 13	P601	60	77	5	H	360	370	385	400	412	541	177
						30	32	33	35	36		
175/70 R 13	P601	70	82	5	H	415	430	445	460	475	576	177
						30	32	33	35	36		
185/60 R 14	P601	60	82	5.5	H	415	430	445	460	475	578	189
						30	32	33	35	36		
185/60 R 15	P601	60	84	5.5	H	435	450	470	485	500	604	189
						30	32	33	35	36		

*Mentioned as Public guide and there maybe minor change according to tire structure.

▶ IMPALA (P670)



Comfort



Fuel Economy



Handling

Technical Specifications

Tire Size	Tread Pattern	Aspect Ratio	Load Index	Rim Width (inch)	Speed Index	Recommended tire inflation pressure for permitted load per tire (Psi/kg)					*Overall Diameter (mm)	*Section Width (mm)
						30	32	33	35	36		
165/65 R 13	P670	65	77	5	T	360	370	385	400	412	544	162

*Mentioned as Public guide and there may be minor change according to tire structure.

▶ **ELPIDA** (P640)



Technical Specifications

Tire Size	Tread Pattern	Aspect Ratio	Load Index	Rim Width (inch)	Speed Index	Recommended tire inflation pressure for permitted load per tire (Psi/kg)					*Overall Diameter (mm)	*Section Width (mm)
						30	32	33	35	36		
185/65 R 14	P640	65	86	5.5	H	460	480	495	515	530	597	190
						30	32	33	35	36		
185/65 R 15	P640	65	88	5.5	H	485	505	525	540	560	622	190
						30	32	33	35	36		

*Mentioned as Public guide and there maybe minor change according to tire structure.

OPTIMAL GRIP (P647)
Special For Taxi



S (Snow)
W (Wet)
D (dry)



Durability



Wet Grip



Fuel Economy



Handling

Technical Specifications

Tire Size	Tread Pattern	Aspect Ratio	Load Index	Rim Width (inch)	Speed Index	Recommended tire inflation pressure for permitted load per tire (Psi/kg)					*Overall Diameter (mm)	*Section Width (mm)
						30	32	33	35	36		
185/65 R 15	P647	65	88	5.5	H	485	505	525	540	560	622	188

*Mentioned as Public guide and there maybe minor change according to tire structure.

▶ **JOOPAR** (P690)

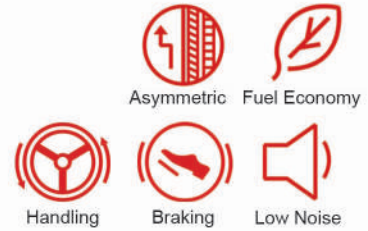

Technical Specifications

Tire Size	Tread Pattern	Aspect Ratio	Load Index	Rim Width (inch)	Speed Index	Recommended tire inflation pressure for permitted load per tire (Psi/kg)					*Overall Diameter (mm)	*Section Width (mm)
						30	32	33	35	36		
185/65 R 14	P690	65	86	5.5	H	460	480	495	515	530	596	189
						30	32	33	35	36		
185/65 R 15	P690	65	88	5.5	H	485	505	525	540	560	623	188
						30	32	33	35	36		

*Mentioned as Public guide and there maybe minor change according to tire structure.

▶ **OPTI DRIVE (P674)**



Technical Specifications

Tire Size	Tread Pattern	Aspect Ratio	Load Index	Rim Width (inch)	Speed Index	Recommended tire inflation pressure for permitted load per tire (Psi/kg)					*Overall Diameter (mm)	*Section Width (mm)
						30	32	33	35	36		
185/65 R 14	P674	65	86	5.5	H	460	480	495	515	530	596	190
185/65 R 15	P674	65	88	5.5	H	485	505	525	540	560	622.5	189

*Mentioned as Public guide and there maybe minor change according to tire structure.

PREMIUM GRIP (P624)



D (dry)
W (Wet)
S (Snow)



Technical Specifications

Tire Size	Tread Pattern	Aspect Ratio	Load Index	Rim Width (inch)	Speed Index	Recommended tire inflation pressure for permitted load per tire (Psi/kg)					*Overall Diameter (mm)	*Section Width (mm)
						30	32	33	35	36		
205/60 R 14	P624	60	88	6	H	30	32	33	35	36	602	209
						485	505	525	540	560		
205/60 R 15	P624	60	91	6	H	30	32	33	35	36	627	209
						535	555	575	595	615		
205/50 R 16	P624	50	87	6.5	V	30	32	33	35	36	612.5	213.5
						475	490	510	525	545		
205/55 R 16	P624	55	91	6.5	V	30	32	33	35	36	632	213
						535	555	575	595	615		
225/55 R 16	P624	55	95	7	V	30	32	33	35	36	655	230
						600	625	645	670	690		
235/55 R 17	P624	55	99	7.5	V	30	32	33	35	36	697	235
						675	700	725	750	775		

*Mentioned as Public guide and there may be minor change according to tire structure.

▶ **OPTIRIDE (P685)**



Technical Specifications

Tire Size	Tread Pattern	Aspect Ratio	Load Index	Rim Width (inch)	Speed Index	Recommended tire inflation pressure for permitted load per tire (Psi/kg)					*Overall Diameter (mm)	*Section Width (mm)
						30	32	33	35	36		
205/60 R 14	P685	60	88	6	H	485	505	525	540	560	602	206
205/60 R 15	P685	60	91	6	H	535	555	575	595	615	627	206
225/45 R 18	P685	45	95	7.5	V	-	630	650	670	690	660	224

*Mentioned as Public guide and there maybe minor change according to tire structure.

▶ OPTI DRIVE Plus (P680)



Tire Size	Tread Pattern	Aspect Ratio	Load Index	Rim Width (inch)	Speed Index	Recommended tire inflation pressure for permitted load per tire (Psi/kg)					*Overall Diameter (mm)	*Section Width (mm)
						30	32	33	35	36		
175/70 R 13	P680	70	82	5	H	415	430	445	460	475	575	177
						30	32	33	35	36		
195/60 R 15	P680	60	88	6	H	485	505	525	540	560	616	200
						30	32	33	35	36		
195/55 R 16	P680	55	87	6	H	475	490	510	525	545	620	198
						30	32	33	35	36		

*Mentioned as Public guide and there maybe minor change according to tire structure.

▶ **Proride (P610)**

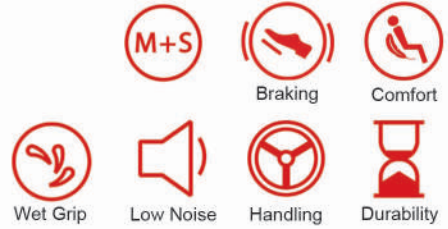

Technical Specifications

Tire Size	Tread Pattern	Aspect Ratio	Load Index	Rim Width (inch)	Speed Index	Recommended tire inflation pressure for permitted load per tire (Psi/kg)					*Overall Diameter (mm)	*Section Width (mm)
						30	32	33	35	36		
205/60 R 14	P610	60	88	6	H	485	505	525	540	560	602	206
205/60 R 15	P610	60	91	6	H	535	555	575	595	615	627	206
205/55 R 16	P610	55	91	6.5	V	535	555	575	595	615	632	212
215/60 R 16	P610	60	99	6.5	V	-	710	730	755	775	669	220

*Mentioned as Public guide and there maybe minor change according to tire structure.

(Sport Utility Vehicle & Crossover Utility Vehicle Radial Tire)



(Sport Utility Vehicle & Crossover Utility Vehicle Radial Tire)

▶ SPORTECH (S630)



Technical Specifications

Tire Size	Tread Pattern	Aspect Ratio	Load Index	Rim Width (inch)	Speed Index	Recommended tire inflation pressure for permitted load per tire (Psi/kg)					*Overall Diameter (mm)	*Section Width (mm)
						30	32	33	35	36		
215/65 R 16	S630	65	98	6.5	H	30 650	32 675	33 700	35 725	36 750	687	220
225/70 R 16	S630	70	103	6.5	H	30 780	32 805	33 830	35 850	36 875	723	230
235/60 R 16	S630	60	100	7	H	30 650	32 675	33 700	35 725	36 750	688	239.7
235/60 R 18	S630	60	103	7	H	30 780	32 805	33 830	35 850	36 875	741	240
265/65 R 17	S630	65	112	8	H	30 975	32 1010	33 1050	35 1085	36 1120	780	270

*Mentioned as Public guide and there maybe minor change according to tire structure.

(Sport Utility Vehicle & Crossover Utility Vehicle Radial Tire)

▶ **RIDE RUNNER (S673)**



Technical Specifications

Tire Size	Tread Pattern	Aspect Ratio	Load Index	Rim Width (inch)	Speed Index	Recommended tire inflation pressure for permitted load per tire (Psi/kg)					*Overall Diameter (mm)	*Section Width (mm)
						30	32	33	35	36		
235/65 R 17	S673	65	104	7	H	805	830	855	875	900	739.8	240
235/55 R 19	S673	55	101	7.5	V	30	32	33	35	36	745	245
						720	745	770	800	825		
225/55 R 18	S673	55	98	7	V	30	32	33	35	36	710	225
						650	675	770	725	750		

*Mentioned as Public guide and there maybe minor change according to tire structure.

(Sport Utility Vehicle & Crossover Utility Vehicle Radial Tire)

▶ **OPTI RIDERUNNER (S677)**

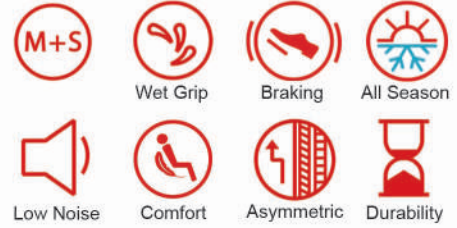

Technical Specifications

Tire Size	Tread Pattern	Aspect Ratio	Load Index	Rim Width (inch)	Speed Index	Recommended tire inflation pressure for permitted load per tire (Psi/kg)					*Overall Diameter (mm)	*Section Width (mm)
						30	32	33	35	36		
225/65 R 17	S677	65	102	6.5	H	760	780	805	830	850	720	230

*Mentioned as Public guide and there maybe minor change according to tire structure.



▶ **LS 890** (All Position)



Technical Specifications

Tire Size	Tread Pattern	Aspect Ratio	Normal ply Rating	Tube Tybe Tubeless	Rim Width (inch)	Speed Index	Permitted Maximum load Per Tire(kg) D S		Maximum Inflation Pressure	*Overall Diameter (mm)	*Section Width (mm)
215/75 R 17.5	LS 890	75	12	Tubeless	6	M	1600	1700	100	767	215
235/75 R 17.5	LS 890	75	14	Tubeless	6.75	M	1900	2000	115	798	235

*Mentioned as Public guide and there maybe minor change according to tire structure.

▶ **LD 892**



Technical Specifications

Tire Size	Tread Pattern	Aspect Ratio	Normal ply Rating	Tube Tybe Tubeless	Rim Width (inch)	Speed Index	Permitted Maximum load Per Tire (kg) D S	Maximum Inflation Pressure	*Overall Diameter (mm)	*Section Width (mm)
235/75 R 17.5	LD 892	75	14	Tubeless	6.75	M	1900 2000	115	805	235

*Mentioned as Public guide and there maybe minor change according to tire structure.

▶ **HB 810**



Technical Specifications

Tire Size	Tread Pattern	Aspect Ratio	Normal ply Rating	Tube Tybe Tubeless	Rim Width (inch)	Speed Index	Permitted Maximum load Per Tire (kg)	Maximum Inflation Pressure	*Overall Diameter (mm)	*Section Width (mm)
275/70 R 22.5	HB 810	70	16	Tubeless	7.5	J	2900	130	997.6	283
							3150			
							3150			

*Mentioned as Public guide and there maybe minor change according to tire structure.

▶ **HB 820**



Technical Specifications

Tire Size	Tread Pattern	Aspect Ratio	Normal ply Rating	Tube Tybe Tubeless	Rim Width (inch)	Speed Index	Permitted Maximum load Per Tire(kg) S		Maximum Inflation Pressure	*Overall Diameter (mm)	*Section Width (mm)
295/80R 22.5	HB 820	80	18	Tubeless	8.25	M	3150	3550	125	1047.5	299
315/80R 22.5	HB 820	80	18	Tubeless	9.00	M	3350	3750	120	1076	316

*Mentioned as Public guide and there maybe minor change according to tire structure.

▶ **HB 800**



Technical Specifications

Tire Size	Tread Pattern	Aspect Ratio	Normal ply Rating	Tube Tybe Tubeless	Rim Width (inch)	Speed Index	Permitted Maximum load Per Tire (kg) D S	Maximum Inflation Pressure	*Overall Diameter (mm)	*Section Width (mm)
315/80R 22.5	HB 800	80	18	Tubeless	9.00	M	3350 4000	130	1073	313

*Mentioned as Public guide and there maybe minor change according to tire structure.

▶ **HS 850**



Technical Specifications

Tire Size	Tread Pattern	Aspect Ratio	Normal ply Rating	Tube Tybe Tubeless	Rim Width (inch)	Speed Index	Permitted Maximum load Per Tire(kg) D S	Maximum Inflation Pressure	*Overall Diameter (mm)	*Section Width (mm)
295/80R 22.5	HS 850	80	16	Tubeless	9.00	M	3350 4000	130	1047.5	299
315/70R 22.5	HS 850	70	18	Tubeless	9.00	M	3150 3550	130	1007	319
315/80R 22.5	HS 850	80	18	Tubeless	9.00	M	3350 4000	130	1076	316

*Mentioned as Public guide and there maybe minor change according to tire structure.

▶ **HS 840**



Technical Specifications

Tire Size	Tread Pattern	Aspect Ratio	Normal ply Rating	Tube Tybe Tubeless	Rim Width (inch)	Speed Index	Permitted Maximum load Per Tire (kg)	Maximum Inflation Pressure	*Overall Diameter (mm)	*Section Width (mm)
315/80R 22.5	HS 840	80	18	Tubeless	9.00	M	3350 4000	130	1078	316

*Mentioned as Public guide and there maybe minor change according to tire structure.

▶ **HS 855**



Technical Specifications

Tire Size	Tread Pattern	Aspect Ratio	Normal ply Rating	Tube Tybe Tubeless	Rim Width (inch)	Speed Index	Permitted Maximum load Per Tire(kg)	Maximum Inflation Pressure	*Overall Diameter (mm)	*Section Width (mm)
315/80R 22.5	HS 855	80	18	Tubeless	9.00	M	3350 3750	130	1076	316

*Mentioned as Public guide and there maybe minor change according to tire structure.

▶ **HD 842**



Technical Specifications

Tire Size	Tread Pattern	Aspect Ratio	Normal ply Rating	Tube Tybe Tubeless	Rim Width (inch)	Speed Index	Permitted Maximum load Per Tire (kg) D S		Maximum Inflation Pressure	*Overall Diameter (mm)	*Section Width (mm)
295/80 R 22.5	HD 842	80	16	Tubeless	9.00	M	3150	3550	125	1048	299

*Mentioned as Public guide and there maybe minor change according to tire structure.

▶ **HD 822**



Technical Specifications

Tire Size	Tread Pattern	Aspect Ratio	Normal ply Rating	Tube Tybe Tubeless	Rim Width (inch)	Speed Index	Permitted Maximum load Per Tire(kg)		Maximum Inflation Pressure	*Overall Diameter (mm)	*Section Width (mm)
							D	S			
315/70R 22.5	HD 822	70	18	Tubeless	9.00	M	3150	3550	130	1018	319
315/80R 22.5	HD 822	80	18	Tubeless	9.00	M	3350	4000	130	1088	323

*Mentioned as Public guide and there maybe minor change according to tire structure.

▶ **HD 882** (ON/OFF)



Technical Specifications

Tire Size	Tread Pattern	Aspect Ratio	Normal ply Rating	Tube Tybe Tubeless	Rim Width (inch)	Speed Index	Permitted Maximum load Per Tire (kg) D S		Maximum Inflation Pressure	*Overall Diameter (mm)	*Section Width (mm)
315/80 R 22.5	HD 882 ON/OFF	80	18	Tubeless	9.00	K	3350	4000	130	1092	323

*Mentioned as Public guide and there maybe minor change according to tire structure.

▶ **HD 812**



Technical Specifications

Tire Size	Tread Pattern	Aspect Ratio	Normal ply Rating	Tube Tybe Tubeless	Rim Width (inch)	Speed Index	Permitted Maximum load Per Tire(kg)	Maximum Inflation Pressure	*Overall Diameter (mm)	*Section Width (mm)
315/80R 22.5	HD 812	80	18	Tubeless	9.00	M	3350 4000	130	1091	317

*Mentioned as Public guide and there maybe minor change according to tire structure.

▶ **HD 802**

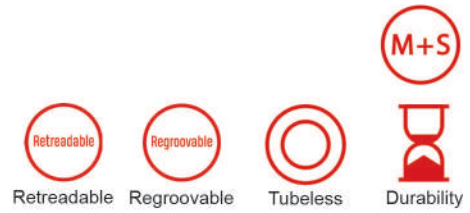

Technical Specifications

Tire Size	Tread Pattern	Aspect Ratio	Normal ply Rating	Tube Tybe Tubeless	Rim Width (inch)	Speed Index	Permitted Maximum load Per Tire(kg)		Maximum Inflation Pressure	*Overall Diameter (mm)	*Section Width (mm)
							D	S			
315/80 R 22.5	HD 802	80	18	Tubeless	9.00	M	3350	3750	130	1089	318

*Mentioned as Public guide and there maybe minor change according to tire structure.

▶ **HT 804**



Technical Specifications

Tire Size	Tread Pattern	Aspect Ratio	Normal ply Rating	Tube Tybe Tubeless	Rim Width (Inch)	Speed Index	Permitted Maximum load Per Tire(kg) D S	Maximum Inflation Pressure	*Overall Diameter (mm)	*Section Width (mm)
385/65R 22.5	HT 804	65	18	Tubeless	11.75	K	4500	130	1065	373

*Mentioned as Public guide and there maybe minor change according to tire structure.

▶ **HT 830** (ON/OFF)



Technical Specifications

Tire Size	Tread Pattern	Aspect Ratio	Normal ply Rating	Tube Tybe Tubeless	Rim Width (inch)	Speed Index	Permitted Maximum load Per Tire ^(kg) D S	Maximum Inflation Pressure	*Overall Diameter (mm)	*Section Width (mm)
385/65 R 22.5	HT 830 ON/OFF	65	20	Tubeless	11.75	K	4500	130	1065	375

*Mentioned as Public guide and there maybe minor change according to tire structure.

▶ **HT 874⁺**



Technical Specifications

Tire Size	Tread Pattern	Aspect Ratio	Normal ply Rating	Tube Tybe Tubeless	Rim Width (Inch)	Speed Index	Permitted Maximum load Per Tire (kg) D S	Maximum Inflation Pressure	*Overall Diameter (mm)	*Section Width (mm)
385/65R 22.5	HT 874*	65	18	Tubeless	11.75	K	4500	130	1062	385

*Mentioned as Public guide and there maybe minor change according to tire structure.

▶ **HT 870** (All axes)



Technical Specifications

Tire Size	Tread Pattern	Aspect Ratio	Normal ply Rating	Tube Tybe Tubeless	Rim Width (inch)	Speed Index	Permitted Maximum load Per Tire(kg) D S	Maximum Inflation Pressure	*Overall Diameter (mm)	*Section Width (mm)
385/55R 22.5	HT 870	55	18	Tubeless	11.75	K	4500	130	995	388
385/65R 22.5	HT 870	65	18	Tubeless	11.75	K	4500	130	1065	373

*Mentioned as Public guide and there maybe minor change according to tire structure.

▶ **HD 862** (ON/OFF)



Technical Specifications

Tire Size	Tread Pattern	Aspect Ratio	Normal ply Rating	Tube Tybe Tubeless	Rim Width (inch)	Speed Index	Permitted Maximum load Per Tire(kg)	Maximum Inflation Pressure	*Overall Diameter (mm)	*Section Width (mm)
12.00 R 24	HD 862 ON/OFF	-	20	Tube Type	8.5	K	4000 4500	120	1223.6	322

*Mentioned as Public guide and there maybe minor change according to tire structure.

▶ **H 860**



Technical Specifications

Tire Size	Tread Pattern	Aspect Ratio	Normal ply Rating	Tube Tybe Tubeless	Rim Width (inch)	Speed Index	Permitted Maximum load Per Tire ^(kg) D S	Maximum Inflation Pressure	*Overall Diameter (mm)	*Section Width (mm)
12.00 R 24	H 860	-	20	Tube Type	8.5	K	4500 4500	120	1217	319

*Mentioned as Public guide and there maybe minor change according to tire structure.

▶ **H 880**



Technical Specifications

Tire Size	Tread Pattern	Aspect Ratio	Normal ply Rating	Tube Tybe Tubeless	Rim Width (inch)	Speed Index	Permitted Maximum load Per Tire(kg) D S	Maximum Inflation Pressure	*Overall Diameter (mm)	*Section Width (mm)
12.00 R 24	H 880	-	20	Tube Type	8.5	K	4000 4500	120	1226	313

*Mentioned as Public guide and there maybe minor change according to tire structure.

LTR (Light Truck Radial Tires, Van)



▶ **L 610**



Technical Specifications

Tire Size	Tread Pattern	Normal ply Rating	Tube Tybe Tubeless	Rim Width (inch)	Speed Index	Permitted Maximum load Per Tire (kg)						*Overall Diameter (mm)	*Section Width (mm)
						S	D	S	D	S	D		
7.00 R 16	L 610	12	Tube Type	5.5	L	73/1110	80/1198	87/1285	73/1080	80/1165	87/1250	778	190

*Mentioned as Public guide and there maybe minor change according to tire structure.

► **L 615**



Technical Specifications

Tire Size	Tread Pattern	Normal ply Rating	Tube Tybe Tubeless	Rim Width (inch)	Speed Index	Permitted Maximum load Per Tire(kg)						*Overall Diameter (mm)	*Section Width (mm)
						S	D						
7.50 R 16	L 615	14	Tube Type	6	M	90/1365	97/1435	105/1510	90/1320	97/1385	105/1460	810	219

*Mentioned as Public guide and there maybe minor change according to tire structure.

▶ **VANMILER**



Technical Specifications

Tire Size	Tread Pattern	Aspect Ratio	Rim Width (inch)	Speed Index	D&S	Load Index	Recommended Tire Pressure(psi) for Permitted load Per Tire(kg)	*Overall Diameter (mm)	*Section Width (mm)
195 R15 C	V695	80	5.5	S	D	104	65/950	685	200
					S	106	65/900		
195 R14 C	V695	80	5.5	S	D	104	65/950	659	200
					S	106	65/900		

*Mentioned as Public guide and there maybe minor change according to tire structure.

PS (Passenger Car Bias Tires)



▶ **SKHX**



Technical Specifications

Tire Size	Tread Pattern	Normal Ply Rating	Rim Width (inch)	Recommended tire inflation pressure for permitted load per tire (Psi/kg)			*Overall Diameter (mm)	*Section Width (mm)
5.60-13	SKHX	4	4	28/370	30/385	32/400	604	150
5.90-13	SKHX	6	4	32/430	34/450	36/470	617	153

*Mentioned as Public guide and there maybe minor change according to tire structure.

LTB, LTT (Light Truck Bias Tires)



► **MRC**



Technical Specifications

Tire Size	Tread Pattern	Normal Ply Rating	Rim Width (inch)	D&S	Recommended tire inflation pressure for permitted load per tire (Psi/kg)			*Overall Diameter (mm)	*Section Width (mm)
6.50-14	MRC	8	4.5	S	–	–	60/795	706	180

*Mentioned as Public guide and there maybe minor change according to tire structure.

► **MRN**



Technical Specifications

Tire Size	Tread Pattern	Normal Ply Rating	Rim Width (inch)	D&S	Recommended tire inflation pressure for permitted load per tire (Psi/kg)			*Overall Diameter (mm)	*Section Width (mm)
					65/794	70/830	75/862		
6.50-16	MRN	10	4.5	D	65/794	70/830	75/862	769	185
				S	65/903	70/943	75/980		
7.00-16	MRN	10	5.5	D	—	—	75/862	794	203
				S	—	—	75/980		
7.50-16	MRN	14	6	D	—	—	90/1310	822	221
				S	—	—	90/1490		
8.25-16	MRN	14	6.5	D	80/1397	85/1449	90/1497	856	235
				S	80/1588	85/1646	90/1701		

*Mentioned as Public guide and there may be minor change according to tire structure.

▶ **ULN**



Technical Specifications

Tire Size	Tread Pattern	Normal Ply Rating	Rim Width (inch)	D&S	Recommended tire inflation pressure for permitted load per tire (Psi/kg)			*Overall Diameter (mm)	*Section Width (mm)
7.50-16	ULN	14	6	D	—	—	90/1310	822	221
				S	—	—	90/1490		
8.25-16	ULN	14	6.5	D	80/1397	85/1449	90/1497	856	235
				S	80/1588	85/1646	90/1701		

*Mentioned as Public guide and there maybe minor change according to tire structure.

► **SEM**



Technical Specifications

Tire Size	Tread Pattern	Normal Ply Rating	Rim Width (inch)	D&S		Recommended tire inflation pressure for permitted load per tire (Psi/kg)		*Overall Diameter (mm)	*Section Width (mm)
				D	S				
8.25-16	SEM	14	6.5	D	—	85/1700	—	856	235
				S	—	85/1800	—		

*Mentioned as Public guide and there maybe minor change according to tire structure.



▶ **H 869**



Technical Specifications

Tire Size	Tread Pattern	Normal Ply Rating	Rim Width (inch)	D&S	Recommended tire inflation pressure for permitted load per tire (Psi/kg)			*Overall Diameter (mm)	*Section Width (mm)
					92/2480	100/2550	105/2630		
10.00-20	H869	16	7.5	D	105/2830	110/2920	115/3000	1072	265
				S				1069	265

*Mentioned as Public guide and there maybe minor change according to tire structure.

KMN



Technical Specifications

Tire Size	Tread Pattern	Normal Ply Rating	Rim Width (inch)	D&S	Recommended tire inflation pressure for permitted load per tire (Psi/kg)			*Overall Diameter (mm)	*Section Width (mm)
10.00-20	KMN	16	7.5	D	95/2480	100/2550	105/2630	1072	265
				S	105/2830	110/2920	115/3000	1069	265
11.00-20	KMN	16	8	D	95/2700	100/2790	105/2870	1088	285
				S	105/3080	110/3180	115/3270		
12.00-20	KMN	16	8.5	D	82/2880	90/2980	95/3080	1138	322
				S	95/3290	100/3400	105/3510		
		18		D	95/3080	100/3170	105/3270		
				S	105/3510	110/3620	115/3720		
12.00-24	KMN	18	8.5	D	95/3460	100/3570	105/3270	1240	322
				S	105/3950	110/4070	115/4190		

*Mentioned as Public guide and there maybe minor change according to tire structure.

► **UTN**



Technical Specifications

Tire Size	Tread Pattern	Normal Ply Rating	Rim Width (inch)	D&S	Recommended tire inflation pressure for permitted load per tire (Psi/kg)			*Overall Diameter (mm)	*Section Width (mm)
12.00-20	UTN	18	8.5	D	95/3080	100/3170	105/3270	1147	322
				S	105/3510	110/3620	115/3720		
12.00-24	UTN	18	8.5	D	95/3460	100/3570	105/3670	1249	322
				S	105/3950	110/4070	115/4190		

*Mentioned as Public guide and there maybe minor change according to tire structure.

▶ **ULN**



Technical Specifications

Tire Size	Tread Pattern	Normal Ply Rating	Rim Width (inch)	D&S	Recommended tire inflation pressure for permitted load per tire (Psi/kg)			*Overall Diameter (mm)	*Section Width (mm)
12.00-24	ULN	18	8.5	D	95/3460	100/3570	105/3270	1240	322
				S	105/3950	110/4070	115/4190		

*Mentioned as Public guide and there maybe minor change according to tire structure.



▶ HRFS



Technical Specifications

Tire Size	Tread Pattern	Rim Width (inch)	Permitted Maximum speed (km/h)	Normal Ply Rating	Recommended tire inflation pressure for permitted load per tire (Psi/kg)			*Overall Diameter (mm)	*Section Width (mm)
6.00-16	HRFS	4.5F	32	6	40/535	45/560	48/600	735	165
7.50-16	HRFS	5.5F	32	6	36/660	40/703	44/748	815	210
				8	48/790	52/830	56/870		
6.50-20	HRFS	5F	32	8	-	-	56/875	868	190

*Mentioned as Public guide and there maybe minor change according to tire structure.

► **FSR**



Technical Specifications

Tire Size	Tread Pattern	Rim Width (inch)	Permitted Maximum speed (km/h)	Normal Ply Rating	Recommended tire inflation pressure for permitted load per tire (Psi/kg)			*Overall Diameter (mm)	*Section Width (mm)
					48/790	52/830	56/870		
7.50-18	FSR	5.5F	32	8	48/790	52/830	56/870	865	203
7.50-20	FSR	5.5F	32	8	36/766	40/810	44/860	915	203

*Mentioned as Public guide and there maybe minor change according to tire structure.

▶ **HLFS**



Technical Specifications

Tire Size	Tread Pattern	Rim Width (inch)	Permitted Maximum speed (km/h)	Normal Ply Rating	Recommended tire inflation pressure for permitted load per tire (Psi/kg)			*Overall Diameter (mm)	*Section Width (mm)
8.25-16	HLFS	6F	30	8	-	-	44/890	840	220
18.4/15-30 **	HLFS	W16L	32	12	-	-	33/3250	1525	467
				14	-	-	42/4500		
18.4/15-34 **	HLFS	W16L	30	10	-	-	26/3000	1636	470
				12	-	-	33/3375		
13.6/12-38	HLFS	W12L	30	10	-	-	36/2215	1570	367
14.00-38	HLFS	W12	30	10	-	-	36/2215	1570	367

*Mentioned as Public guide and there maybe minor change according to tire structure.

**Tire sizes with the two-star symbol can be used for Combine front wheel as well.

G 10



Technical Specifications

Tire Size	Tread Pattern	Rim Width (inch)	Permitted Maximum speed (km/h)	Normal Ply Rating	Recommended tire inflation pressure for permitted load per tire (Psi/kg)			*Overall Diameter (mm)	*Section Width (mm)
12.4-24	G 10	W11	30	8	24/1190	26/1240	29/1320	1160	315
14.9-24	G 10	W13	32	10	–	–	36/2650	1265	378
12.4/11-28	G 10	W11	30	8	–	–	33/1510	1260	315
7.50-18	G 10	5.5F	30	8	–	–	52/945	860	205
18.4/15-30 **	G 10	W16L	32	12	–	–	33/3250	1525	467
				14	–	–	42/4500		
18.4/15-34 **	G 10	W16L	30	12	–	–	33/3375	1636	470
18.4/15-38	G 10	W16L	30	12	–	26/3075	31/3413	1340	444

*Mentioned as Public guide and there maybe minor change according to tire structure.

**Tire sizes with the two-star symbol can be used for Combine front wheel as well.

G 20



Technical Specifications

Tire Size	Tread Pattern	Rim Width (inch)	Permitted Maximum speed (km/h)	Normal Ply Rating	Recommended tire inflation pressure for permitted load per tire (Psi/kg)			*Overall Diameter (mm)	*Section Width (mm)
13.6/12-38	G 20	W12	30	12	-	-	32/220	1350	370
14.00-38	G 20	W16	30	12	-	26/3075	31/3413	1340	444

*Mentioned as Public guide and there maybe minor change according to tire structure.

▶ **G 30**



Technical Specifications

Tire Size	Tread Pattern	Rim Width (inch)	Permitted Maximum speed (km/h)	Normal Ply Rating	Recommended tire inflation pressure for permitted load per tire (Psi/kg)			*Overall Diameter (mm)	*Section Width (mm)
14.9-28	G 30	W13	30	12	–	–	33/230	1380	390
13.6-28	G 30	W12	30	12	–	–	32/220	1350	370

*Mentioned as Public guide and there maybe minor change according to tire structure.

▶ **RB 10**



Technical Specifications

Tire Size	Tread Pattern	Rim Width (inch)	Permitted Maximum speed (km/h)	Normal Ply Rating	Recommended tire inflation pressure for permitted load per tire (Psi/kg)			*Overall Diameter (mm)	*Section Width (mm)
6.00-16	RB 10	4.5E	30	8	-	65/450	-	735	165

*Mentioned as Public guide and there maybe minor change according to tire structure.



▶ **Q 10**



Technical Specifications

Tire Size	Tread Pattern	Normal Ply Rating	Tube Type Tubeless	Rim Width (inch)	Maximum Depth Tread (mm)	Maximum Permitted Load Per Tire (kg)	Maximum Inflation Pressure (psi)	*Overall Diameter (mm)	*Section Width (mm)
17.5-25	Q 10	20	Tube Type	14.00/1.5	27	8250	70	404	1335
20.5-25	Q 10	20	Tube Type	17.00/2.0	31.5	9500	65	490	1490
23.5-25	Q 10	20	Tube Type	19.50/2.5	33.5	10900	53	554	1592
		24	Tube Type	19.50/2.5	33.5	12500	65		

*Mentioned as Public guide and there maybe minor change according to tire structure.

► **Q 20**



Technical Specifications

Tire Size	Tread Pattern	Normal Ply Rating	Tube Type Tubeless	Rim Width (inch)	Maximum Depth Tread (mm)	Maximum Permitted Load Per Tire (kg)	Maximum Inflation Pressure (psi)	*Overall Diameter (mm)	*Section Width (mm)
17.5-25	Q 20	20	Tube Type	14.00/1.5	33	8250	70	404	1335
20.5-25	Q 20	20	Tube Type	17.00/2.0	38	9500	65	490	1490
23.5-25	Q 20	20	Tube Type	19.50/2.5	36.5	10900	53	554	1592
		24	Tube Type	19.50/2.5	36.5	12500	65		

*Mentioned as Public guide and there maybe minor change according to tire structure.

Tire Performance Diagram

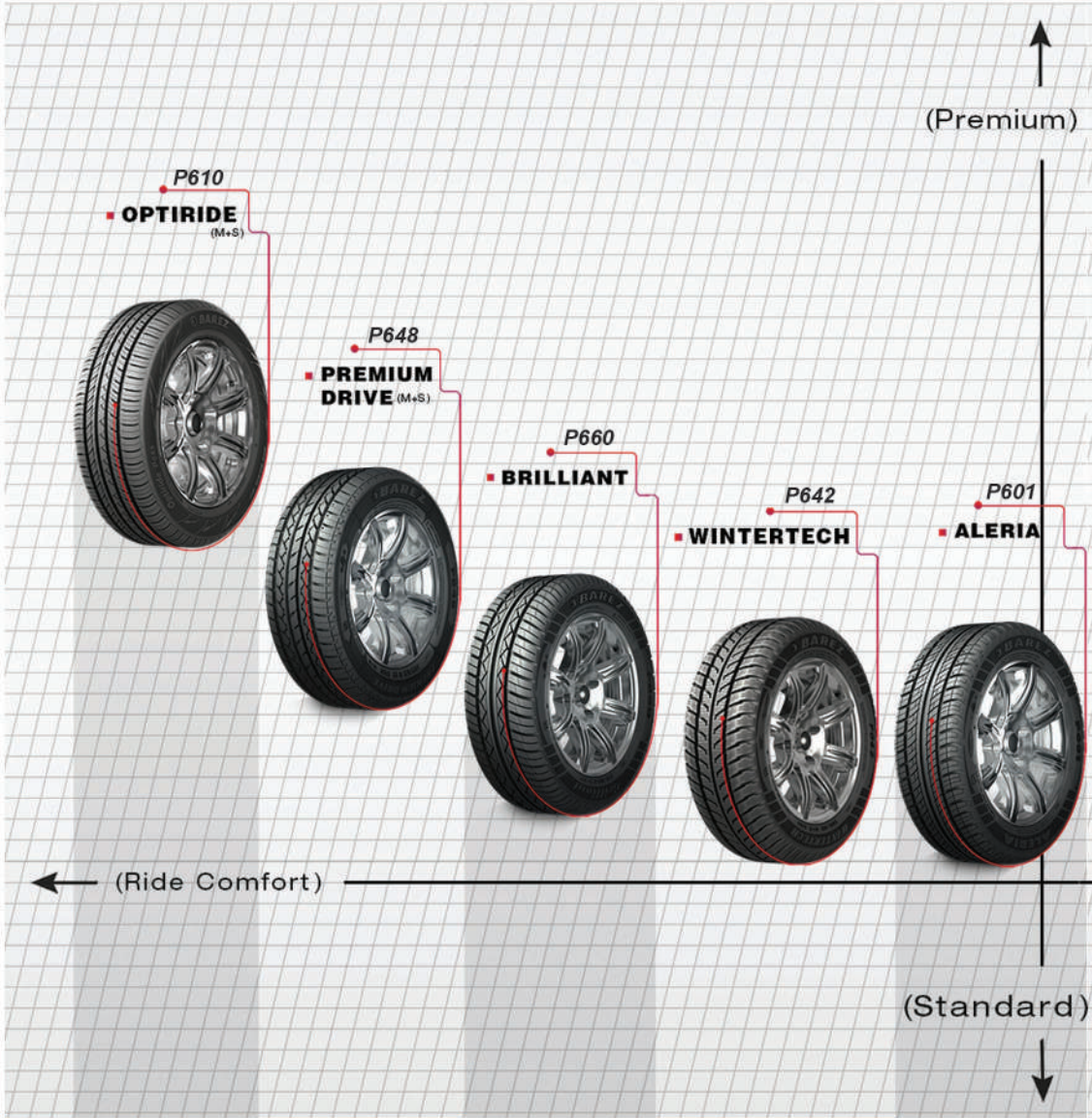



Introduction to signs and specifications on the tire

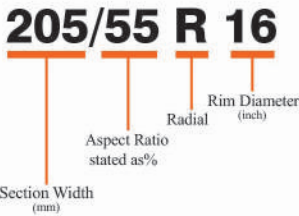

Speed Domain: Speed domain means the maximum speed at which a tire is allowed to move and remain perfect for a certain period of time under the certain permissible load and wind under special laboratory conditions.

Symbol	Speed Domain	Symbol	Speed Domain	Symbol	Speed Domain
A 3	15km/h	A 2	10km/h	A 1	5km/h
A 6	30km/h	A 5	25km/h	A 4	20km/h
B	50km/h	A 8	40km/h	A 7	35km/h
E	70km/h	D	65km/h	C	60km/h
J	100km/h	G	90km/h	F	80km/h
M	130km/h	L	120km/h	K	110km/h
Q	160km/h	P	150km/h	N	140km/h
T	190km/h	S	180km/h	R	170km/h
V	240km/h	H	210km/h	U	200km/h
Z	Over 300km/h	Y	300km/h	W	270km/h

Tire Specification

PCR

Tire Size	Tread Pattern	Aspect Ratio	Load Index	Rim Width (inch)	Speed Index	Recommended tire inflation pressure for permitted load per tire (P _{st} /kg)					Overall Diameter (mm)	Section Width (mm)	
165/65R13	P648	65	77	5	T	30/360	32/370	33/385	35/400	36/412	545	168.3	
185/65R14		65	86	5.5	H	30/480	32/480	33/495	35/515	36/530	594	189	
185/65R15		65	88	5.5	H	30/485	32/505	33/525	35/540	36/560	622	188	
195/65R15		65	91	6	H	30/535	32/555	33/575	35/595	36/615	636	199	
165/65R13	P660	65	77	5	T	30/360	32/370	33/385	35/400	36/412	544	170	
175/60R13		60	77	5	H	30/360	32/370	33/385	35/400	36/412	541	178.5	
175/70R13		70	82	5	H	30/415	32/430	33/445	35/460	36/475	576	178.5	
185/65R14		65	86	5.5	H	30/460	32/480	33/495	35/515	36/530	596	188.7	
185/70R14	70	88	5.5	T	30/485	32/505	33/525	35/540	36/560	614	189		
165/65R13	P642	65	76	5	T	30/360	32/370	33/385	35/400	36/412	544	170	
175/70R13		70	82	5	T	30/415	32/430	33/445	35/460	36/475	576	177	
185/65R14		65	86	5.5	H	30/480	32/480	33/495	35/515	36/530	597.5	188.5	
185/65R15		65	88	5.5	H	30/485	32/505	33/525	35/540	36/560	622.5	188.5	
175/60R13	P601	60	77	5	H	30/360	32/370	33/385	35/400	36/412	541	177	
175/70R13		70	82	5	H	30/415	32/430	33/445	35/460	36/475	576	177	
185/60R14		60	82	5.5	H	30/415	32/430	33/445	35/460	36/475	578	189	
185/60R14		60	84	5.5	H	30/435	32/450	33/470	35/485	36/500	604	189	
165/65R13	P670	65	77	5	T	30/360	32/370	33/385	35/400	36/412	622	188	
185/65R14	P640	65	86	5.5	H	30/480	32/480	33/495	35/515	36/530	597	190	
185/65R15		65	86	5.5	H	30/485	32/505	33/525	35/540	36/560	622	190	
165/65R13	P647	65	88	5.5	H	30/485	32/505	33/525	35/540	36/560	622	188	
185/65R14	P690	65	88	5.5	H	30/485	32/505	33/525	35/540	36/560	596	189	
185/65R15		65	88	5.5	H	30/485	32/505	33/525	35/540	36/560	623	188	
185/65R14	P674	65	88	5.5	H	30/460	32/480	33/495	35/515	36/530	596	190	
185/65R15		65	88	5.5	H	30/485	32/505	33/525	35/540	36/560	622.5	189	
205/60R14	P624	60	88	6	H	30/485	32/505	33/525	35/540	36/560	602	209	
205/60R15		60	91	6	H	30/535	32/555	33/575	35/595	36/615	627	209	
205/50R16		50	87	6.5	V	30/475	32/490	33/510	35/525	36/545	612.5	213.5	
205/55R16		55	91	6.5	V	30/535	32/555	33/575	35/595	36/615	632	213	
225/55R16		55	95	7	V	30/600	32/625	33/645	35/670	36/690	655	230	
235/55R17		55	99	7.5	V	30/675	32/700	33/725	35/750	36/775	697	235	
205/60R14		P685	60	88	6	H	30/485	32/505	33/525	35/540	36/560	602	206
205/60R15			60	91	6	H	30/535	32/555	33/575	35/595	36/615	627	206
225/45R18	P680	45	91	7.5	V		38/630	39/650	41/670	42/690	660	224	
175/70R13		70	82	5	H	30/415	32/430	33/445	35/460	36/475	575	177	
195/60R15		60	88	6	H	30/485	32/505	33/525	35/540	36/560	616	200	
195/55R16		55	87	6	H	30/475	32/490	33/510	35/525	36/545	620	198	
215/65R16		65	98	6.5	H	30/650	32/675	33/700	35/725	36/750	687	220	
225/70R16		70	103	6.5	H	30/780	32/805	33/830	35/850	36/875	723	230	
235/60R16		S630	60	100	7	H	30/650	32/675	33/700	35/725	36/750	627	209
235/60R18			60	103	7	H	30/780	32/805	33/830	35/850	36/875	622	188
265/65R17	S673	65	112	8	H	30/975	32/1010	33/1050	35/1085	36/1120	780	270	
235/65R17		65	104	7	H	30/805	32/830	33/855	35/875	36/900	739.8	240	
235/55R19		55	101	7.5	V	30/720	32/745	33/770	35/800	36/825	745	245	
225/55R18		55	98	7	V	30/650	32/675	33/700	35/725	36/750	710	225	
225/65R17		S677	65	102	6.5	H	30/780	32/780	33/805	35/830	36/850	720	230

Tire Specification

TBR

Tire Size	Tread Pattern	Aspect Ratio	Normal ply rating	Tubeless/Tube type	Rim Width (inch)	Speed Index	permitted maximum load per tire (Psi/kg)		Maximum Inflation Pressure	*Overall Diameter (mm)	*Section Width (mm)			
							S	D						
215/75R17.5	LS890	75	12	Tubeless	6	M	1800	1700	100	767	215			
235/75R17.5		75	14	Tubeless	6.75		1900	2000				115	798	235
235/75R17.5	LD892	75	14	Tubeless	6.75	M	1900	2000	115	805	235			
275/70R22.5	HB810	70	16	Tubeless	7.5	J	2900	3150	130	977.6	283			
295/80R 22.5	HB820	80	16	Tubeless	8.25	M	3150	3550	125	1047.5	299			
315/80R22.5					9.00		3350	3750				120	1076	316
315/80R22.5	HB800	80	18	Tubeless	9.00	M	3350	4000	130	1073	313			
295/80R 22.5	HS850	80	16	Tubeless	9.00	M	3350	4000	130	1047.5	299			
315/70R22.5		70	18				3150	3550				130	1007	319
315/80R22.5		80	18				3350	4000				130	1076	316
315/80R22.5	HS840	80	18	Tubeless	9.00	M	3350	4000	130	1078	316			
315/80R22.5	HS855	80	18	Tubeless	9.00	M	3350	3750	130	1076	316			
295/80R22.5	HD842	80	16	Tubeless	9.00	M	3150	3550	125	1048	299			
315/70R22.5	HD822	70	18	Tubeless	9.00	M	3150	3550	130	1018	319			
315/80R22.5		80	18	Tubeless	9.00	M	3350	4000	130	1088	323			
315/80R22.5	HD882	80	18	Tubeless	9.00	M	3350	4000	130	1092	323			
315/80R22.5	HD812	80	18	Tubeless	9.00	M	3350	4000	130	1091	317			
315/80R22.5	HD802	80	18	Tubeless	9.00	M	3350	3750	130	1089	318			
385/65R22.5	HT804	65	18	Tubeless	11.75	K	4500		130	1065	373			
385/65R22.5	HT830	65	20	Tubeless	11.75	K	4500		130	1065	375			
385/65R22.5	HT874*	65	18	Tubeless	11.75	K	4500		130	1062	385			
385/65R22.5	HT870	55	18	Tubeless	11.75	K	4500		130	995	388			
385/65R22.5		65	18	Tubeless	11.75	K	4500		130	1065	373			
12.00R24	HD862	-	20	Tube Type	8.5	K	4000	4500	120	1223.5	322			
12.00R24	H860	-	20	Tube Type	8.5	K	4000	4500	120	1217	319			
12.00R24	H880	-	20	Tube Type	8.5	K	4000	4500	120	1226	313			

LTR

Tire Size	Tread Pattern	Normal ply rating	Tubeless/Tube type	Rim Width (inch)	Speed Index	Recommended Tire Pressure for Permitted Load Per Tire (psi/kg)						*Overall Diameter (mm)	*Section Width (mm)
						S			D				
7.00R16	L610	12	Tube Type	5.5	L	73/1110	70/1198	87/1285	73/1080	80/1165	87/1250	778	190
7.50R16	L615	14	Tube Type	6	M	90/1365	97/1435	105/1510	90/1320	97/1385	105/1460	810	219

Tire Size	Tread Pattern	Aspect Ratio	Rim Width (inch)	Speed Index	D&S	Load Index	Recommended Tire Pressure for Permitted Load Per Tire (psi/kg)		*Overall Diameter (mm)	*Section Width (mm)
							S	D		
195R15C	V695	80	5.5	S	D	104	65/950		685	200
195R14C							65/900			
195R14C	V695	80	5.5	S	D	104	65/950		659	200
195R14C							65/900			

PS

Tire Size	Tread Pattern	Normal ply rating	Rim Width (inch)	Recommended Tire Pressure for Permitted Load Per Tire (psi/kg)			*Overall Diameter (mm)	*Section Width (mm)
				28/370	30/385	32/400		
5.60-13	SKHX	4	4	28/370	30/385	32/400	604	150
5.90-13	SKHX	6	4	32/430	34/450	36/470	617	153

Tire Specification

LTB

Tire Size	Tread Pattern	Rim Width (inch)	Normal ply rating	D&S	Recommended Tire Pressure for Permitted Load Per Tire (psi/kg)			*Overall Diameter (mm)	*Section Width (mm)
6.50-14	MRC	4.5	8	S	—	—	60/795	706	180
6.50-16	MRN	4.5	10	D	65/794	70/830	75/862	769	185
				S	65/903	70/943	75/980		
7.00-16		5.5	10	D	—	—	75/862	794	203
				S	—	—	75/980		
7.50-16		6	14	D	—	—	90/1310	822	221
				S	—	—	90/1490		
8.25-16		6.5	14	D	80/1397	85/1449	90/1497	856	235
				S	80/1588	85/1646	90/1701		
7.50-16	ULN	6	14	D	—	—	90/1310	822	221
				S	—	—	90/1490		
8.25-16		6.5	14	D	80/1397	85/1449	90/1497	856	235
				S	80/1588	85/1646	90/1701		
8.25-16	SEM	6.5	14	D	—	85/1700	856	235	
				S	—	85/1800			—

TB

Tire Size	Tread Pattern	Rim Width (inch)	Normal ply rating	D&S	Recommended Tire Pressure for Permitted Load Per Tire (psi/kg)			*Overall Diameter (mm)	*Section Width (mm)
10.00-20	H869	7.5	16	D	95/2480	100/2550	105/2630	1072	265
				S	105/2830	110/2920	115/3000	1069	265
10.00-20	KMN	7.5	16	D	95/2480	100/2550	105/2630	769	265
				S	105/2830	110/2920	115/3000		
11.00-20		8	16	D	95/2700	110/3180	105/2870	794	203
				S	105/3080	110/3180	115/3270		
12.00-20		8.5	16	D	82/2880	90/2980	95/3080	822	221
				S	95/3290	100/3400	105/3510		
12.00-20		8.5	18	D	95/3080	100/3170	105/3270	822	221
				S	105/3510	110/3620	115/3720		
12.00-24	8.5	18	D	95/3460	100/3570	105/3270	1240	322	
			S	105/3950	110/4070	115/4190			
12.00-20	UTN	8.5	18	D	95/3080	100/3170	105/3270	1147	322
				S	105/3510	110/3620	115/3720		
12.00-24		8.5	18	D	95/3460	100/3570	105/3270	1249	322
			S	105/3950	110/4070	115/4190			
12.00-24	ULN	8.5	18	D	95/3460	100/3570	105/3270	1240	322
				S	105/3950	110/4070	115/4190		

Tire Specification

AG

Tire Size	Tread Pattern	Rim Width (inch)	Normal ply rating	Permitted Maximum Speed(km/h)	Recommended Tire Inflation Pressure for Permitted Load Per Tire(psi/kg)			*Overall Diameter (mm)	*Section Width (mm)
6.00-16	HRFS	4.5F	6	32	40/535	45/560	48/600	735	165
7.50-16		4.5F	6 8	32	36/660 48/790	40/703 52/830	44/748 56/870	815	210
6.50-20		5F	8	32	-	-	56/875	868	190
7.50-18	FSR	5.5F	8	32	48/790	52/830	56/870	865	203
7.50-20		5.5F	8	32	36/766	40/810	44/860	915	203
8.25-16	HLFS	6F	8	30	-	-	44/890	840	220
18.4/15-30		W16L	12	32	-	-	33/3250	1525	467
			14		-	-	42/4500		
18.4/15-34		W16L	10	30	-	-	26/3000	1636	470
			12		-	-	33/3375		
13.6/12-38		W12L	10	30	-	-	36/2215	1570	367
14.00-38		W12	10	30	-	-	36/2215	1570	367
12.4-24	G10	W11	8	32	24/1190	26/1240	29/1320	1160	315
14.9-24		W13	10	32	-	-	36/2650	1265	378
12.4/11-28		W11	8	32	-	-	33/1510	1260	315
7.50-18		5.5F	8	32	-	-	52/945	860	205
18.4/15-30		W16L	12	32	-	-	33/3250	1525	467
			14		-	-	42/4500		
18.4/15-34		W16L	12	32	-	-	33/3375	1636	470
18.4/15-38		W16L	12	32	-	26/3075	31/3413	1340	444
13.6/12-38	G20	W12	12	30	-	-	32/220	1350	370
14.00-38		W16L	12	30	-	26/3075	31/3413	1340	444
14.9-28	G30	W13	12	30	-	-	33/230	1380	390
13.6-28		W12	12	30	-	-	32/220	1350	370
6.00-16	RB10	4.5E	8	30	-	65/450	-	735	165

OTR

Tire Size	Tread Pattern	Rim Width (inch)	Normal ply rating	Tubeless/Tube Type	Maximum Depth Tread(mm)	Maximum Permitted Load per Tire(psi)	Maximum Inflation Pressure(psi)	*Overall Diameter (mm)	*Section Width (mm)
17.5-25	Q10	14.00/1.5	20	Tube Type	27	8250	70	404	1335
20.5-25		17.00/2.0	20	Tube Type	31.5	9500	65	490	1490
23.5-25		19.50/2.5	20	Tube Type	33.5	10900	53	554	1592
		19.50/2.5	24		33.5	12500	65		
17.5-25	Q20	14.00/1.5	20	Tube Type	33	8250	70	404	1335
20.5-25		17.00/2.0	20	Tube Type	38	9500	65	490	1490
23.5-25		19.50/2.5	20	Tube Type	36.5	10900	53	554	1592
		19.50/2.5	24		36.5	12500	65		



1

EDITION

BAREZ INDUSTRIAL GROUP
GENERAL CATALOGUE 2022-2023

Head Office



No.103,West Hoveizeh St.,Sohrevardi Ave.,P.O.Box : 15875-3711 , Tehran,I.R.Iran
Tel:+98(21) 88766721-4 , Fax: +98(21) 88767155 , Postal Code : 15536-16411

Kerman Factory

25km Joopar Road , Kerman,I.R.Iran
Tel:+98(34) 32269760-7 , Fax: +98(34) 32223853

Kordestan Factory

Sanandaj-Hamedan highway, Kordestan,I.R.Iran
Tel:+98(87) 35155062 , Fax: +98(21) 35155061

 www.barez.org  [barez.tires](https://www.instagram.com/barez.tires)  [@barezpr](https://www.telegram.com/@barezpr)

